

# WHAT MOVES YOU MOVES US

That's why at **Courtyard by Marriott Toronto Downtown**, everything is designed to help you feel completely energized during your stay, from delicious, nourishing meals at The Bistro to our sparkling heated pool and state-of-the-art fitness centre. The world's largest **full-service Courtyard by Marriott**, our hotel offers a fashionable minimalist vibe through all 575 spacious guest rooms and 13,500 square feet of flexible meeting space. Conveniently situated at the heart of Yonge and College Streets and close to all of Toronto's top attractions, you'll find all you need to pursue your passion, whether at work or at play, because our passion is to help you follow yours.





### A PERFECT DAY STARTS WITH A PERFECT NIGHT

Enjoy an excellent night's sleep, so you're ready for whatever tomorrow brings. Our 575 modern guest rooms and suites feature complimentary high-speed Wi-Fi access, pillowtop mattresses, mini fridge, 24-hour room service, and 55" LED TVs with cable channels and Hulu, Netflix and YouTube streaming at no charge (subscription required).

### WAKE UP YOUR DAY AND WIND IT DOWN AT THE BISTRO

Enjoy everything from a fresh, hearty breakfast and Starbucks® coffee each morning to bistro classics and our signature Bites & Boards at lunch and dinner. With signature crafted cocktails and craft beers for evening mingling, there's something for everyone.

### PASSION PUT INTO EVERY SPACE

From the state-of-the-art fitness centre to the refreshed meeting rooms, our spaces are designed to fuel your energy and inspire your best. Pick up essentials for your stay at the 24-hour market or catch up on work commitments at the business centre.

### MOVING FORWARD WITH MORE

Marriott Bonvoy™ is the new name for our combined loyalty program that includes Marriott Rewards®, The Ritz-Carlton Rewards® and SPG®. With one set of benefits, you have more opportunities to earn and redeem in more places. Join to earn points toward free nights, flights and more. Visit [members.marriott.com](https://members.marriott.com) to discover the benefits of membership.

### AN IDEAL LOCATION

Conveniently located in the heart of Toronto at Yonge and College Streets, next to business and government offices, the subway, restaurants and premier entertainment.

- Convenient Location: Close to Yonge-Dundas Square, The Village, the Metro Toronto Convention Centre, the CF Toronto Eaton Centre, Toronto General Hospital, Massey Hall, the CN Tower, Scotiabank Arena, Rogers Centre, Art Gallery of Ontario, Royal Ontario Museum, and Bloor-Yorkville fashion district
- 4.7 kilometres (2.9 miles) from Billy Bishop Toronto City Airport (YTZ) and 27 kilometres (16.8 miles) from Toronto Pearson International Airport (YYZ)

### MEETINGS AND EVENTS

We have 13,500 square feet of flexible event space that's perfect for weddings, corporate meetings and events.

- 19 versatile venues
- Elegant setup for functions with up to 350 guests
- Full-service Food and Beverage for all catering needs

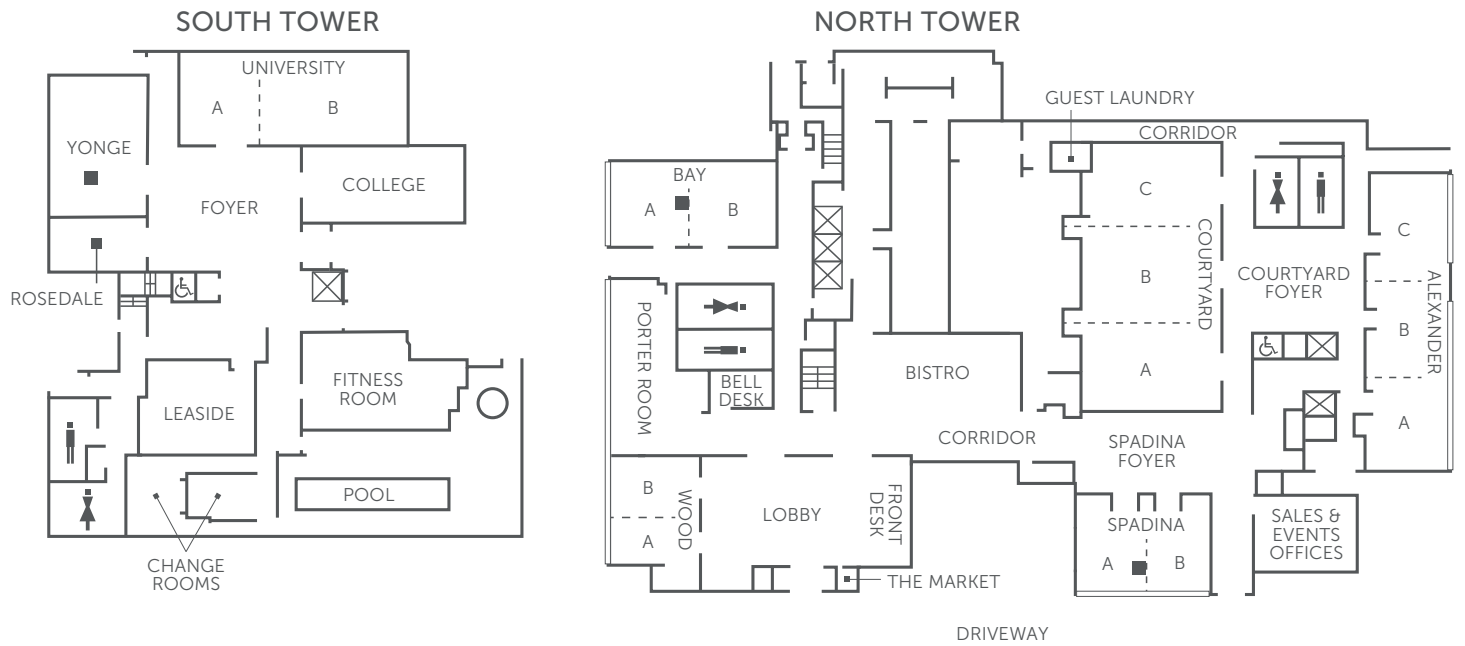

## CAPACITY CHART

MEETING ROOM	DIM. (LxW)	SQ FT	THEATRE	CLASSROOM	HOLLOW SQUARE	U-SHAPE	RECEPTION	BANQUET (8S)*	BANQUET (10S)*	BOARDROOM
ALEXANDER	19x100	1,962	190	120	—	—	200	144	180	—
ALEXANDER A	19x30	610	55	30	26	21	60	40	50	20
ALEXANDER B	19x32	637	55	30	26	21	60	40	50	30
ALEXANDER C	19x36	715	64	35	30	24	80	48	60	34
BAY	43x25	1,075	84	40	—	—	100	72	90	—
BAY A	23x25	575	45	24	24	20	55	40	50	17
BAY B	20x25	500	35	18	22	18	50	32	40	17
COLLEGE	18x39	702	75	30	28	24	80	48	60	30
COURTYARD HALL	38x91	3,458	380	224	—	—	450	264	330	—
COURTYARD A	38x29	1,102	120	54	42	35	140	80	100	30
COURTYARD B	38x32	1,216	140	60	46	37	160	88	110	40
COURTYARD C	38x29	1,102	120	54	42	35	140	80	100	30
COURTYARD FOYER	—	—	—	—	—	—	150	—	—	—
LEASIDE	19x28	532	35	25	22	20	50	32	40	18
PORTER	58x21	1,218	120	72	55	50	120	80	100	45
ROSEDALE	13x22	286	—	—	—	—	—	—	—	10
SPADINA	40x30	1,200	80	40	38	29	115	80	100	26
SPADINA A	20x30	600	45	25	22	18	55	40	50	20
SPADINA B	20x30	600	45	25	26	22	60	40	50	20
SPADINA FOYER	—	—	—	—	—	—	60	—	—	—
UNIVERSITY	21x59	1,239	120	75	50	45	120	88	110	40
UNIVERSITY A	21x21	441	35	18	20	15	40	24	30	14
UNIVERSITY B	21x38	798	75	35	32	28	75	56	70	26
UNIVERSITY FOYER	—	—	—	—	—	—	80	—	—	—
YONGE	33x21	693	50	20	16	12	60	32	40	20
WOOD	30x36	1,076	90	56	38	32	115	72	90	30
WOOD A	30x19	570	50	35	30	26	60	40	50	28
WOOD B	30x17	510	32	26	28	25	50	32	40	26

\*Banquet is set with 60-inch round tables of 8 or 10. Room capacity may change depending on audiovisual requirements.